

LANDSCAPE NOTES:

- All work to be carried out in accordance with by-laws and codes having jurisdiction over site location.
- Complete all work to the satisfaction of the Landscape Architect.
- Report any changes, discrepancies or substitutions to the Landscape Architect for review. Obtain approval from the Landscape Architect before proceeding.
- It is the contractor's responsibility to determine existing service locations.
- Exact locations of plant material will be determined by placement of site services such as hydro vaults, meters, utilities roof rain water leaders, driveways, light standards, etc.
- All plant material locations to be staked or marked out and approved by Landscape Architect prior to installation.
- Supply all plant material in accordance with the Canadian Standards for Nursery Stock (CNS).
- Install plant material according to details shown.
- Disturbed soil areas around trees and shrubs are to be covered with shredded conifer bark mulch such as 'Canada Red' or 'Gro-Bark' mulch, or approved equivalent. Alternative mulches must be approved by the Landscape Architect.
- Contractor to utilize layout dimensions where provided.
- Provide planting bed area as noted on the drawing or to accommodate mature size of plant material.
- All support systems must be removed by the contractor at time of final acceptance. No extras will be paid to complete this work.
- Supply and place topsoil in accordance with OPSS 570 to a minimum depth of 150mm unless otherwise specified.
- Supply and place sod in accordance with OPSS 572 unless otherwise specified.
- Supply and place seed in accordance with OPSS 572 unless otherwise specified. All 5:1 or greater slopes to be seeded with lucifer. Contractor to provide necessary erosion control protection as required to ensure soil stabilization and proper seed germination.
- All dimensions in meters unless otherwise noted.
- If discrepancies arise between plant material count shown on drawing and plant list, the drawing shall be considered correct.
- Contractor to provide minimum two (2) year warranty (including trees on municipal property) from date accepted on all work unless otherwise specified.
- Any site plan or grading and servicing shown is for information only. Refer to approved drawings.
- Not for construction unless stamped, signed and dated by Landscape Architect.
- Drawings not to be reproduced without written consent from Landscape Architect.
- Approval of landscape plan to be obtained from municipality.
- All plant material to be planted a minimum of 1.0m from any swales or ditches.
- For grading and servicing information refer to the consulting Engineer's drawings.
- For lighting information and power distribution refer to the electrical consultant's drawings.

BUFFER PLANTING NOTES:

- All plant substitutions to be reviewed and approved by Landscape Architect and Hamilton Conservation Authority.
- Impact to existing plantings to be minimized:
 - where possible, no trampling of existing roots of established native vegetation;
 - access routes to be discussed on site to limit disturbance.
- Shrub, grass and forb planting beds to be augmented with triple mix topsoil and mulched.
- Much depth of 75mm to be added to proposed wildflower and forb/grasses beds to reduce encroachment by opportunistic species.

SEED NOTES:

- Areas to be seeded shall receive an application of naturalization seed at the rate of 25 kg/hectare or 2 kg/100m² for spot applications, in the following mixture:
Low Maintenance Retention Basin Mix*

Virginia Wild Rye (Elymus virginicus)	25%
Bottle-Brush Grass (Elymus hystrix)	25%
Fox Sedge (Carex vulpinoidea)	25%
Fowl Bluegrass (Poa palustris)	25%

Bank Seed Mix*

Little Bluestem (Schizachyrium scoparium)	30%
Black-Eyed Susan (Rudbeckia hirta)	6%
Bottle-Brush Grass (Elymus hystrix)	5%
Fowl Bluegrass (Poa palustris)	30%
Fowl Mannagrass (Glyceria striata)	2%
Fox Sedge (Carex vulpinoidea)	25%
New England Aster (Aster novae-angliae)	2%

*apply with annual oats (Avena sativa) nursecrop at 22kg/hectare.
Supplied by:
Ontario Seed Company (or approved equal)
P: 1-519-886-0557
W: www.oscseeds.com
- Seeding and mulching with hydraulic mulch shall be a one-step process in which seed, fertilizer and hydraulic mulch are applied simultaneously in a water slurry via the hydraulic seeder/mulcher. Hydraulic mulch to be approved by the Landscape Architect shall be applied at the rate of 100kg per hectare.
- Depending on slope gradation the depth of composted soil and seed mix shall be as follows:

0-5% slope:	10 - 15mm depth
5-10% slope:	15 - 20mm depth
10-25% slope:	20 - 25mm depth
25-35% slope:	25 - 40mm depth
35-45% slope:	40 - 50mm depth
- The contractor shall not carry out the work under adverse weather conditions such as high wind, frozen ground or ground covered with snow, ice or standing water.
- Grade seeded bed to a uniform surface and remove vegetation which may interfere with seeding operations. Loosen soil to depth of 25mm minimum and remove stones and foreign material which protrude more than 75mm above the surface.
- Seeded areas to be maintained by contractor ensuring adequate water, fertilizer, maintenance and repair until seeded areas are properly established. Areas seeded in fall will be accepted in following spring, one month after start of growing season provided acceptance conditions are fulfilled.

KEY MAP - N.T.S.



LEGEND

- existing right-of-way
- existing tree
- proposed deciduous tree
- proposed multi-stem large shrub
- proposed shrub
- proposed perennial
- min. 150mm topsoil, fine grade & seed (basin mix)
- min. 150mm topsoil, fine grade & seed (bank mix)
- aquatic plugs (1.0m O.C.)

NOT FOR CONSTRUCTION
ISSUED FOR REVIEW & COMMENTS ONLY

REVISIONS/ SUBMISSIONS

#	DATE	DESCRIPTION
1	2017-04-26	Issued for review/ coordination
2	2017-08-21	Issued for review/ coordination
3	2017-08-24	Issued for review/ coordination
4	2017-08-28	Issued for review/ coordination

STAMP

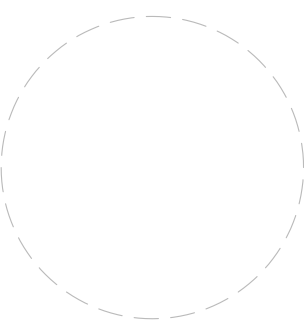

CLIENT

Losani Homes

MUNICIPALITY

City of Hamilton

PROJECT

Central Park,
Wetland Restoration

MUNICIPAL FILE NUMBER

SPA 17-000

SHEET

Planting Plan

L-1

adesso design inc.
landscape architecture



218 Locke Street South, 2nd Floor
Hamilton, ON L8P 4B4
t. 905.526.8876
www.adessodesigninc.ca

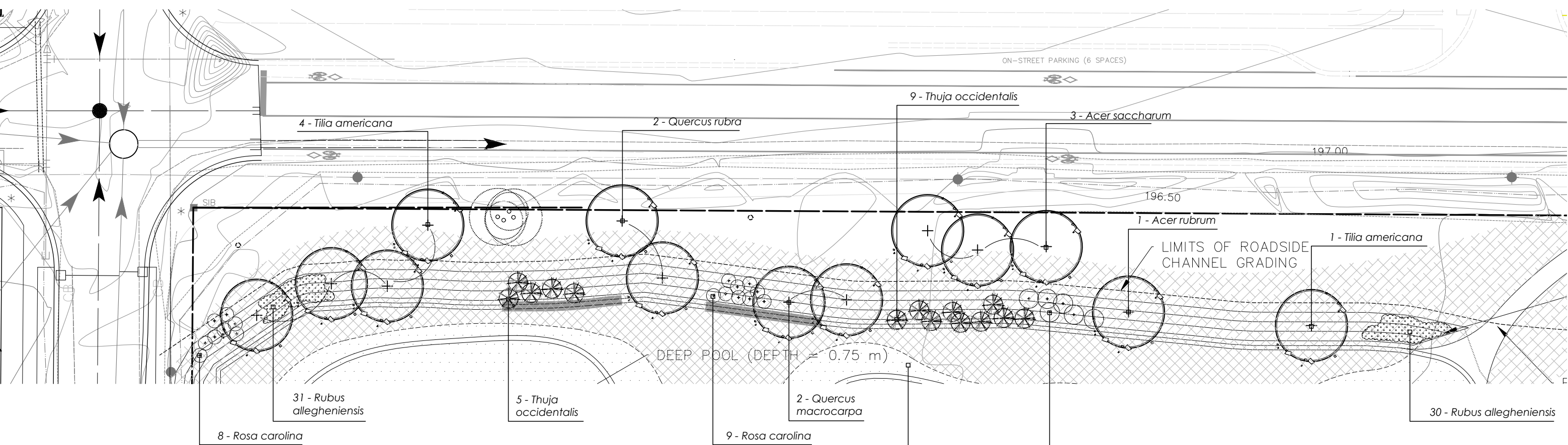

'A' - Buffer Berm Planting Plan

SCALE 1:400