

# Sharing Experiences

## A Workshop For Groups and Individuals Who Undertake Environmental Projects

### Agenda

- 8:45 - 9:00** Registration
- 9:00 - 9:15** **Opening Remarks**  
Youth Delegates to the International Symposium on Biodiversity
- 9:20 - 9:40** **Linking Local Action to the International Year of Biodiversity**  
Leslie Adams - P.O.W.E.R.
- 9:45 - 10:00** **Habitat Creation from Planning to Planting**  
Vicki Beard - Pollination Guelph
- 10:05 - 10:20** **Monitoring the Success of Habitat Creation Projects**  
Alice Casselman - A.C.E.R.
- 10:25 - 10:40** **Break**
- 10:45 - 11:05** **Community Based Social Marketing**  
Theresa Sauren - Reduce the Juice
- 11:10 - 11:30** **Getting Organized and Strategizing**  
Ken Woodruff - Save the General Brock Parklands Committee
- 11:35 - 11:50** **Taking Stewardship to Permanent Protection**  
Michelle Albanese - Orland Conservation
- 12:00 - 1:00** **Lunch**
- 1:15** **Breakout Sessions** (see reverse for schedule)
- 3:30** **Closing Remarks**
- 3:45** **Adjournment**

Sponsored by:

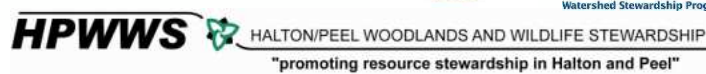

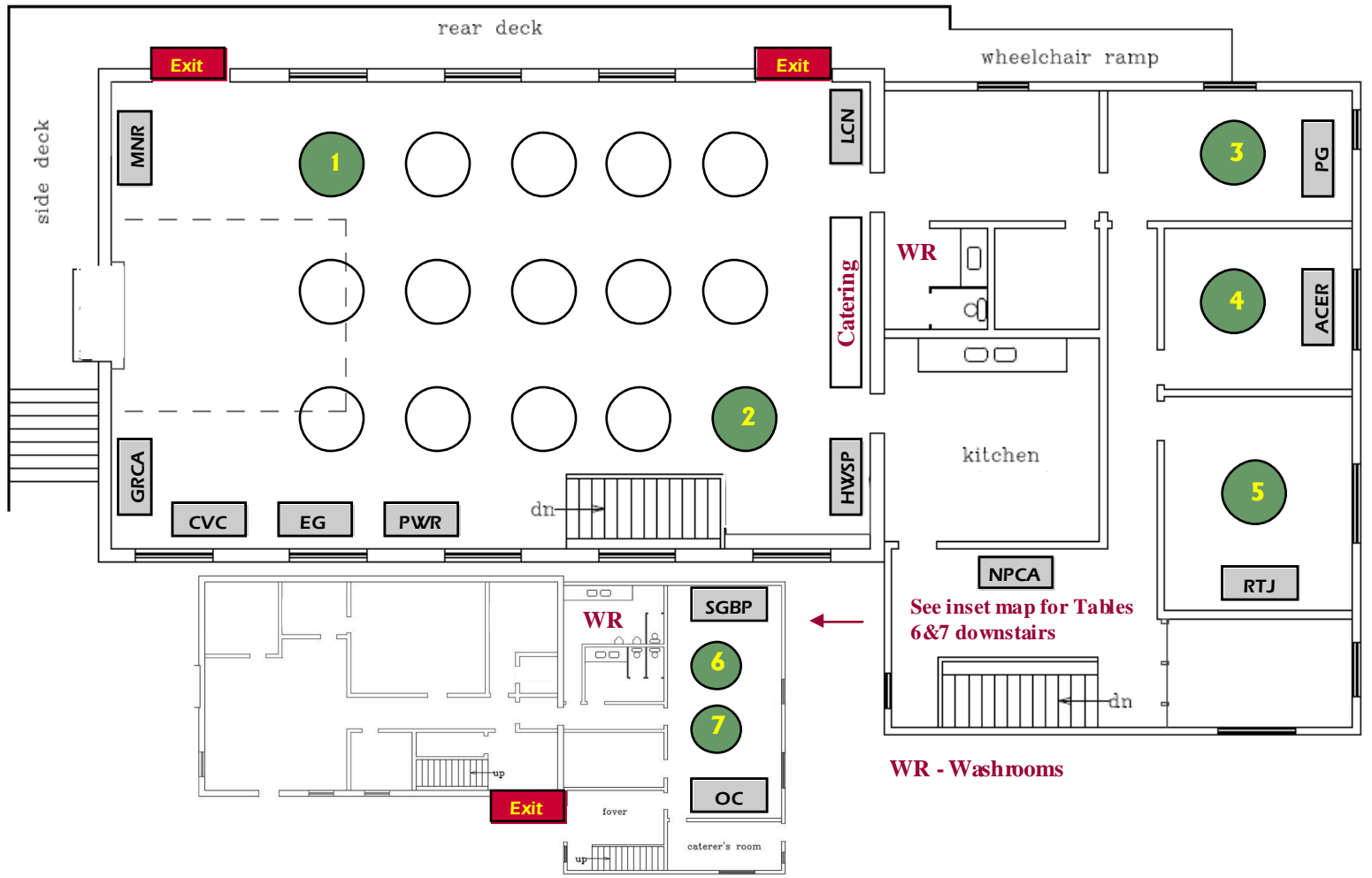

**Afternoon Breakout Sessions**

All seven sessions will run in all five timeslots, you will be able to attend 5 out of the 7 sessions. The session numbers listed below correspond to the room locations on the layout map above.

1. Kim McNeilly (Evergreen) - **Volunteer Management and Funding Programs**
2. Leslie Adams (P.O.W.E.R.) - **Linking Local Action to the International Year of Biodiversity**
3. Vicki Beard (Pollination Guelph) - **Habitat Creation from Planning to Planting**
4. Alice Casselman (A.C.E.R.) - **Monitoring the Success of Habitat Creation Projects**
5. Theresa Sauren (Reduce the Juice) - **Community Based Social Marketing**
6. Ken Woodruff (Save the General Brock Parklands Committee) - **Getting Organized and Strategizing**
7. Michelle Albanese (Orland Conservation) - **Taking Stewardship to Permanent Protection**

**What Breakout Sessions will you attend?**

Plan your breakout sessions schedule here!

Start Time	Topic/Leader	Room Location
1:15 - 1:35		
1:40 - 2:00		
2:05 - 2:25		
2:30 - 2:40	<b>Break</b>	
2:45 - 3:05		
3:05 - 3:30		

**Organizations with Displays**

The acronyms listed below correspond to the display locations on the layout map above.

- ACER** - Association for Canadian Educational Resources
- CVC** - Credit Valley Conservation
- EG** - Evergreen
- GRCA** - Grand River Conservation Authority
- HWSP** - Hamilton-Halton Watershed Stewardship Program
- LCN** - Land Care Niagara
- MNR** - Halton-Peel Woodlands for Wildlife Stewardship Council  
- Hamilton-Wentworth Stewardship Council  
- Wellington County Stewardship Council
- NPCA** - Niagara Peninsula Conservation Authority
- OC** - Orland Conservation
- PG** - Pollination Guelph
- PWR** - P.O.W.E.R.
- RTJ** - Reduce the Juice
- SGBP** - Save the General Brock Parklands Committee